

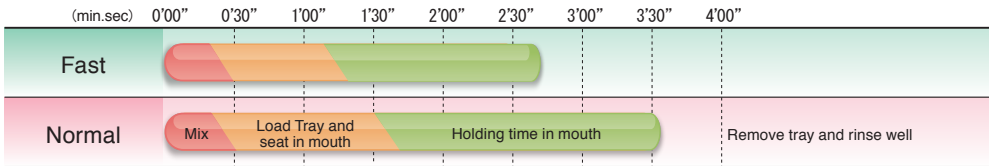

AROMA FINE PLUS Physical Properties

Setting types	Working time from start of mix (room temperature 23°C water temperature 23°C)	Holding time in mouth	Compressive strength	Strain in compression	Recovery from deformation
Fast	1 min. 10 sec	1 min. 30 sec.	0.7MPa	14.6%	97.1%
Normal	1 min. 30 sec	2 min.			



*Room and water temperature at 23°C

Directions for use

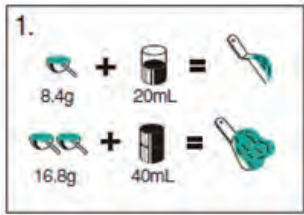

Measurement guidelines

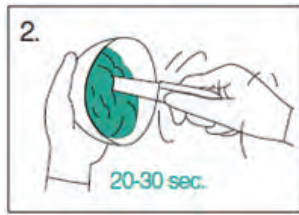

Spatulate vigorously

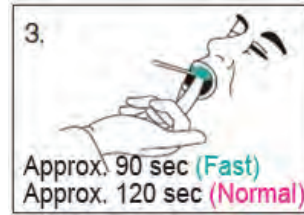

Hold tray in the mouth
Refreshing spearmint smell for patient comfort

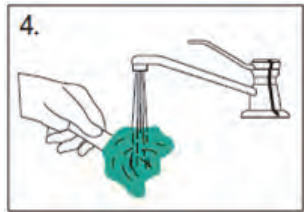

Rinse the impression under running water, and remove excess water

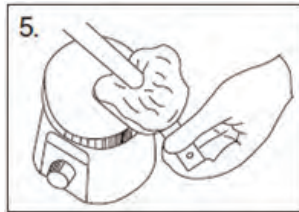

Pour cast immediately

Recommended gypsum

GC FUJIROCK® EP (type 4)



NEW PLASTONE (type 3)



Packaging

AROMA FINE PLUS is available in:

- 1kg
- 500g



eXperience

NEW an EVEN EASIER to mix AROMA FINE with
AROMA FINE PLUS

ALGINATE IMPRESSION MATERIAL

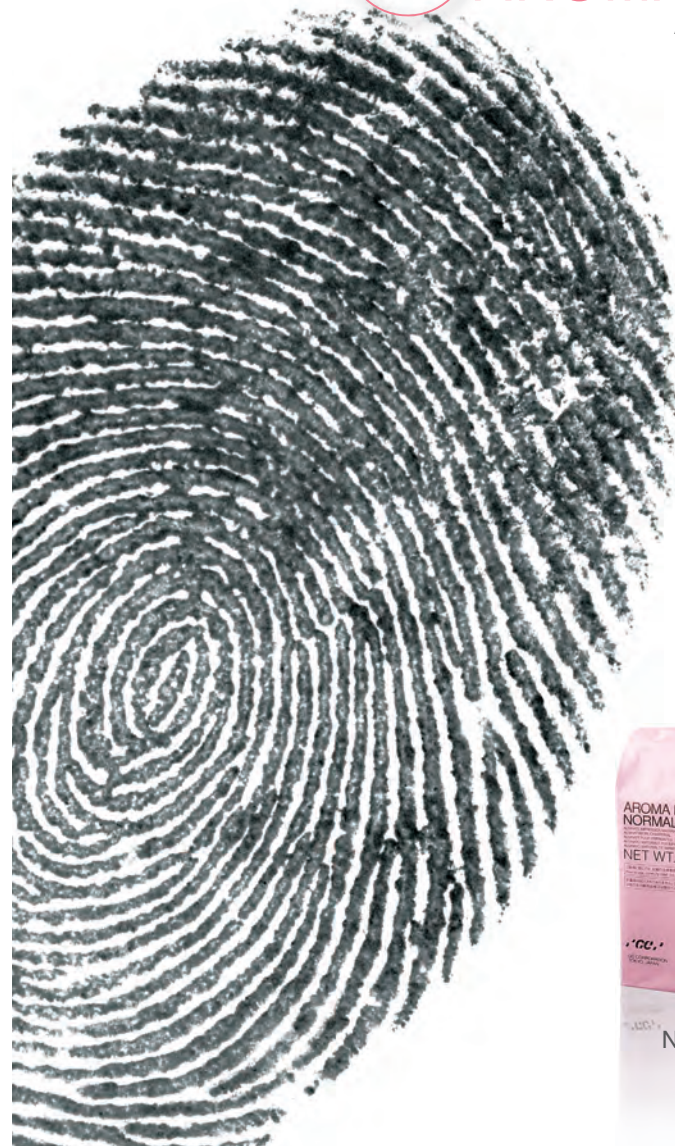

NORMAL

FAST



GC ASIA DENTAL PTE LTD
19 Loyang Way #06-27
Changi Logistics Centre
Singapore 508724

T +65 6546 7588
F +65 6546 7577
E gcasia@singnet.com.sg
www.gcasia.info

In just **3** seconds

The powder is incorporated rapidly into water through enhanced powder-water affinity allowing more spatulation time to obtain a smooth bubble-free mix within 20 seconds.

AROMA FINE PLUS



Fine & smooth mixture

AROMA FINE DF-III



*Indicates the starting and ending time

Reliable properties of AROMA FINE remain unchanged.

Accurate impression



Easy-mixing of AROMA FINE PLUS results in a creamy, bubble-free consistency that captures details accurately.

Smooth model surface



AROMA FINE PLUS has good compatibility with hard stones producing smooth and precise detail reproduction on the gypsum model.

NEW PLASTONE LE

Optimal thixotropic property



AROMA FINE PLUS provides a balance of good drip resistance and fluidity to effectively provide coverage enabling detailed impression taking with minimal discomfort to the patient.